

Accessories: Slot diffuser

AVAILABLE IN LENGTHS OF 500 TO 6,000 MM

At a glance:

- **Simple installation using screws offset on the inside**
- **Corrosion-resistant aluminium anodized AIMgSiOF22, 3 or 4 mm**
- **Available lengths 500 to 6,000 mm, precise to 10 mm**
- **With fixed or removable centre piece for ease of cleaning**
- **End cover supplied mounted or loose**
- **With hygiene certificate**

Menerga slot diffusers allow steady and effective distribution of air and heat in a room. They are only minimal visible and easy to install. They are mounted on window fronts in swimming pool halls in order to keep the windows mist-free and

can also be used in every other building type. The introduction of the air via slot diffusers prevents draughts at floor level. Build-up of heat is also avoided in the event of strong sunlight.

Application area swimming pool hall

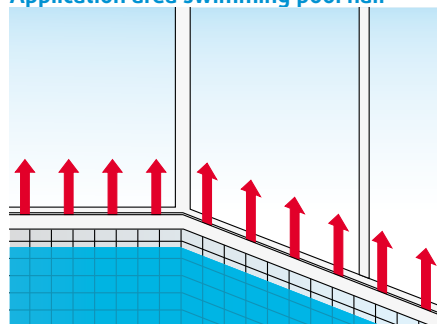

Application area office building

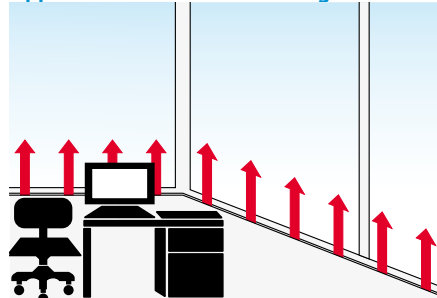

Example of installation

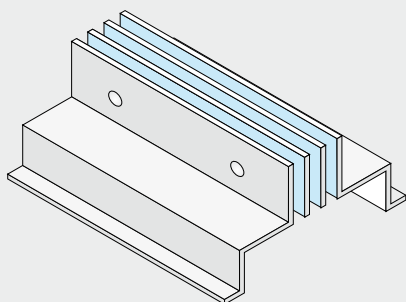
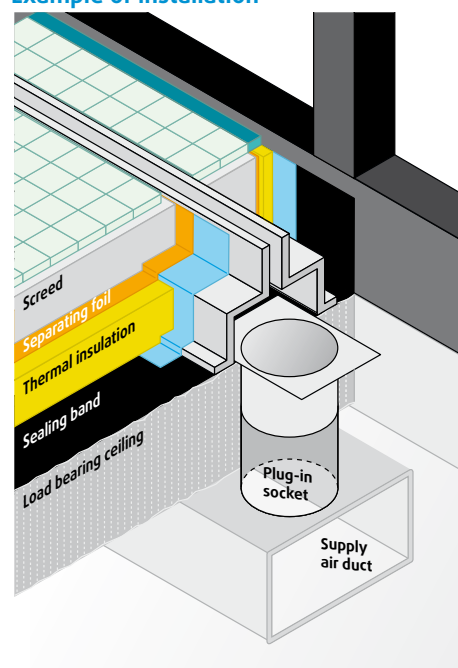

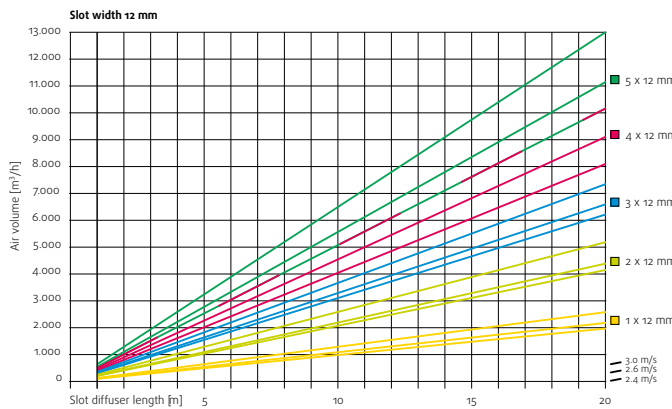
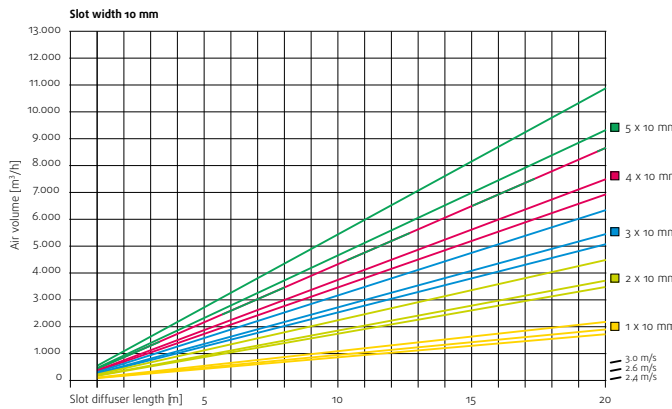
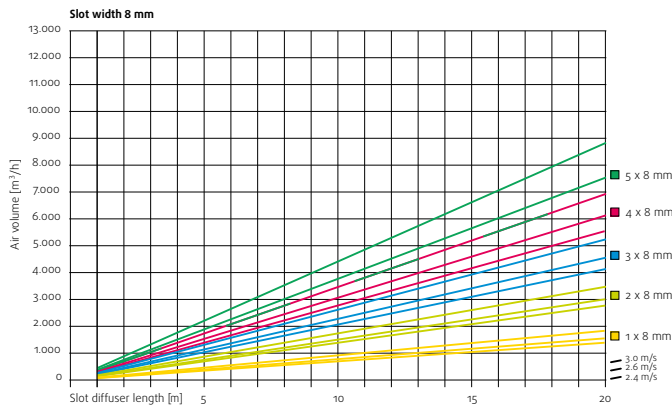

Available lengths and Cross-sections

Length 500-6000mm can be ordered up to 10 mm precisely. Consider linear expansion during assembly! In floor range of public swimming pool halls exclusively type A is permitted!

- Type A = Slot width 8 mm
- Type B = Slot width 10 mm
- Type C = Slot width 12 mm

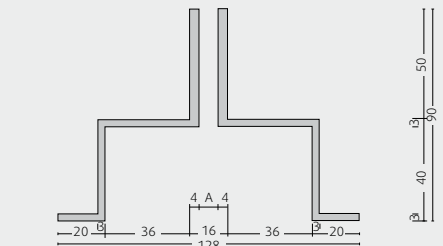

Type A1=1x8 | Type B1=1x10 | Type C1=1x12

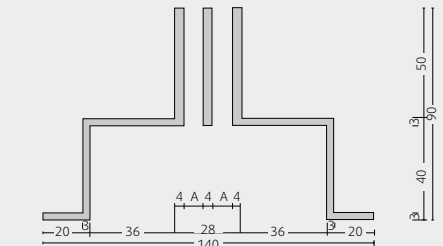

Type A2=2x8 | Type B2=2x10 | Type C2=2x12

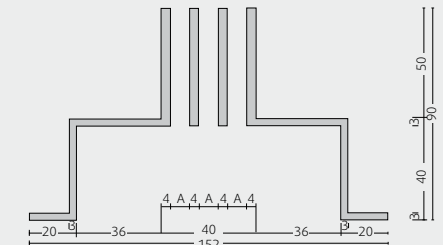

Type A3=3x8 | Type B3=3x10 | Type C3=3x12

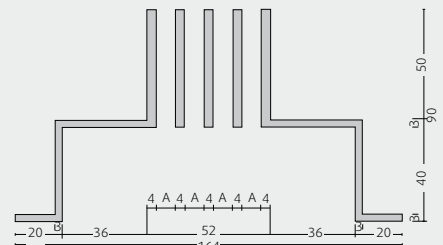

Type A4=4x8 | Type B4=4x10 | Type C4=4x12

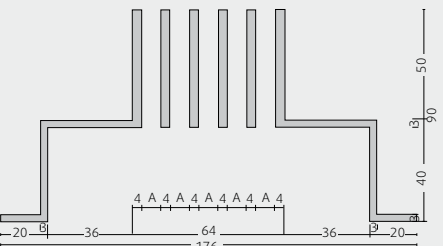

Type A5=5x8 | Type B5=5x10 | Type C5=5x12

Optional miter cuts

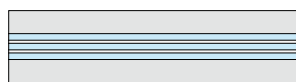

Type I



Type II | 45° left



Type III | 45° right



Type IV | 45° both sides

Accessories

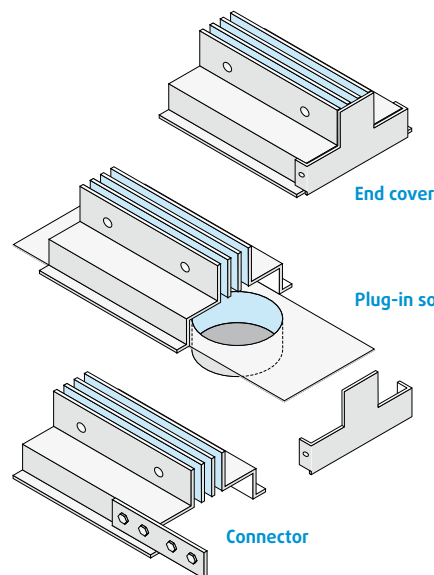

End cover

Plug-in socket

Connector